

Model No :: **31010-BS/OPL**
 Name :: Geneva



Project Name :: _____
 Location :: _____
 Type :: _____
 Quantity :: _____
 Notes :: _____

Product Information

Product ID :: 31010
 UPC Code :: 641594128390
 Mounting Type :: Wall
 Finish :: Brushed Steel (BS)
 Diffuser :: Opal (OPL)
 Alt. Finishes :: Brushed Steel (BS); Chrome (CH)
 Alt. Diffusers :: Frosted (FST); Opal (OPL)

Product Dimensions

Fixture	Canopy
Length :: N/A	Length :: 24.5"
Width :: 24.5"	Width :: 2.25"
Diameter :: N/A	Diameter :: N/A
Extension :: 3.5"	Height :: 1.25"
Height :: 4"	
Overall Height :: N/A	



Technical Specifications

Qualifications

Location Rating :: Damp
 Certification :: ETL Listed (US/Canada)
 IES File ::
 JA8 Compliant :: No
 Energy Star :: No
 ADA Compliant :: Yes
 Marine Grade :: No
 Emergency Lighting :: No
 Warranty :: 1 Year Limited

Specifications

Frame Material :: Metal
 Diffuser Material :: Glass
 Voltage :: 120v
 Lamping Type :: Fluorescent
 Lamping Base :: Bi-Pin
 Lamp Quantity :: 1
 Lamp Wattage :: 24 W
 Total Wattage :: 24w
 Lamps Included :: Yes
 J-Box Type :: Standard

Photometrics

CCT :: 3000
 CRI :: N/A
 Wattage :: 24w
 Nominal Lumens :: 1750Lm
 Delivered Lumens :: N/A

Recommended Dimmers

0

Additional Items :: 0

Line Drawing #1

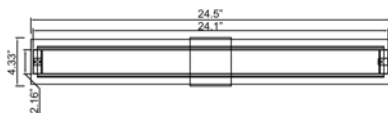

Line Drawing #2

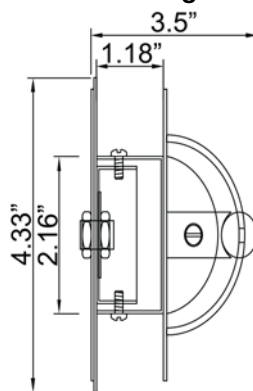

IES File

Image Not Available

Toll Free 800-828-5483 • www.AccessLighting.com

14410 Myford Road, Irvine, CA 92606

The information provided is subject to change without notice. ©2020 Access Lighting Corporation. All Rights Reserved
 Rev. 202004 Filename:: 31010-BS_OPL.pdf

