

Alban Outdoor Wall

8518301, 8718301, 8520701, 8720701 | 1.1

GENERATION LIGHTING

Outdoor

CAUTION - RISK OF FIRE
This product must be installed in accordance with the applicable installation code by a person familiar with the construction and operation of the product and the hazards involved.
Use minimum 90°c supply conductors.

GENERAL PRODUCT INFORMATION:

These fixtures are intended to be installed utilizing NEC compliant junction boxes.

This product is safety listed for wet locations.

Incandescent lamps may be dimmed with a standard incandescent dimmer. LED lamps may be dimmed with a LED dimmer. Consult lamp manufacturer for additional information.

GENERATION LIGHTING

7400 Linder Ave, Skokie, IL 160077
800.969.3347

www.generationlighting.com

© 2020 Generation Lighting. All rights reserved.
The "Generation Lighting" graphic is a registered trademark of Generation Lighting. Generation Lighting reserves the right to change specifications for product improvements without notification.

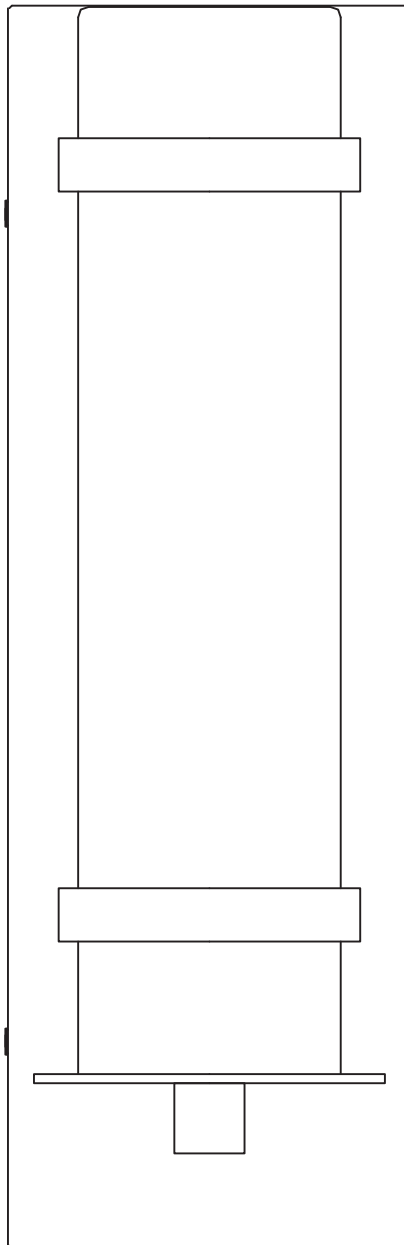

SAVE THESE INSTRUCTIONS!

Install the Fixture

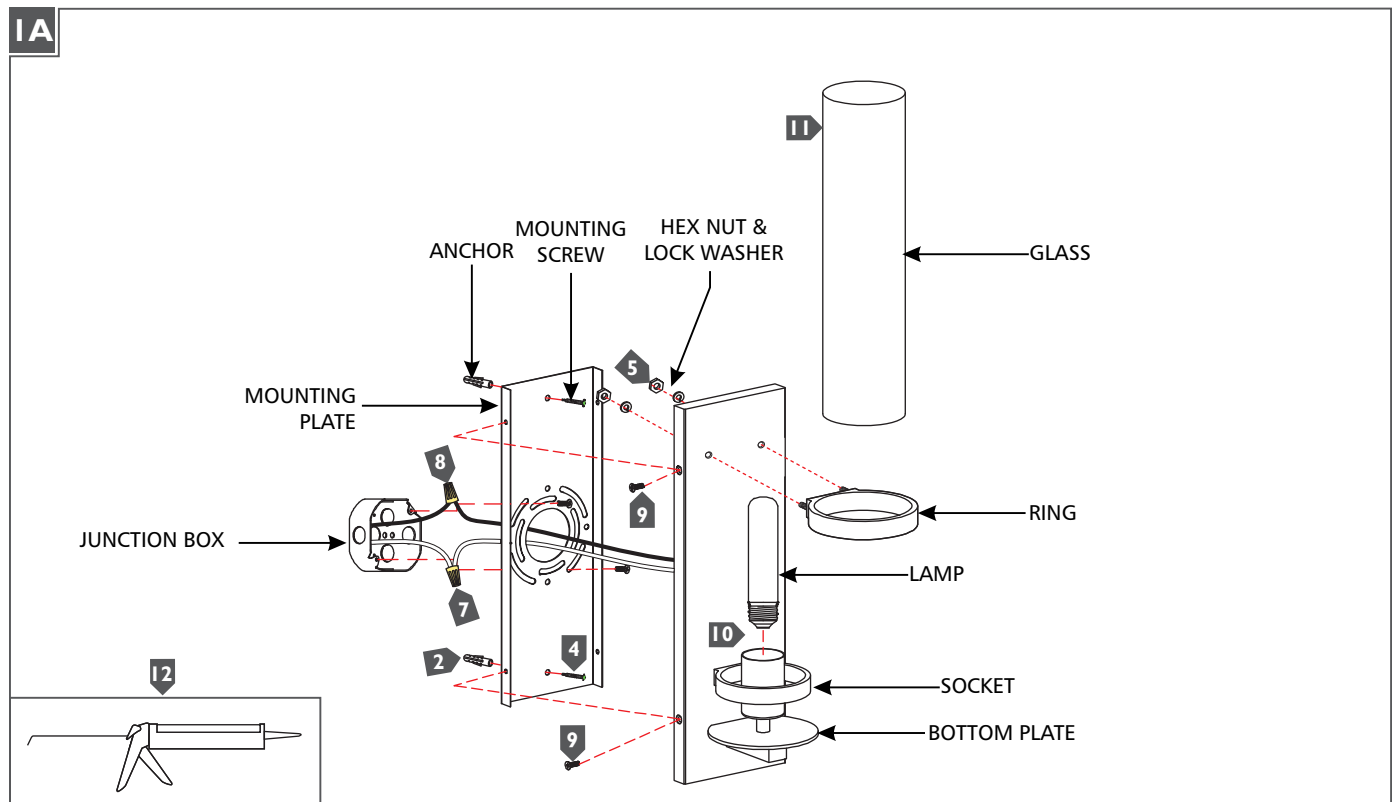

- 1** Temporarily install the mounting plate to the junction box and mark the anchor hole locations through the mounting plate holes. Remove the mounting plate.
- 2** Drill appropriate sized holes at the marked locations and install the anchors.
- 3** Secure the mounting plate to the junction box.
- 4** Screw the anchor screws into the anchors.
- 5** Install the ring onto the fixture base and secure in place with provided lock washers and hex nuts.
- 6** Connect the fixture to a suitable ground in accordance with local electrical codes.
- 7** Connect the white fixture wire to the neutral power line wire with a wire nut.
- 8** Connect the black fixture wire to the hot power line wire with a wire nut.
- 9** Mount the fixture base onto the mounting plate and secure it with the fixture screws.
- 10** Screw the lamp into the socket. Refer to the label on the socket for Max Wattage Information.
- 11** Align the glass to the ring and slide it carefully into the ring allowing it to rest on the bottom plate.
- 12** For wet locations, caulk around the base of the fixture with waterproof construction sealant.