

ERIS Outdoor
3-721-xx

oxygen

FIXTURE TYPE _____

LOCATION _____

PROJECT _____

DATE _____



-16 Gray



-22 Oiled Bronze

LIGHT SOURCE	2 x 10.1W LED, 3000K, CRI 90
LUMINAIRE POWER	24.0W at 120V
RATED LIFE	60000 hr RL
OPTIONAL COLOR TEMPERATURES	2700K, 3500K, 4000K
LUMEN OUTPUT	Delivered: 807 lm (LM-79)
INPUT VOLTAGE	120V to 277V AC, 50/60Hz
DRIVER OUTPUT	700mA, 29.4W max power
DIMMING	TRIAC and ELV dimming at 120V AC; 0-10V dimming, 100% to 1% current output
CONSTRUCTION	Cast Aluminum and Glass
DIFFUSER	- Frosted Glass
FINISHES	Gray (-16), Oiled Bronze (-22)
MOUNTING	4" Octagonal J-Box*, 4" Square J-Box* *Deep J-Box (Required to house driver) (Installer must provide a bead of caulk between fixture housing and mounting surface)
STANDARDS	UL Wet listed, Conforms to UL STD 1598, Certified CAN/CSA STD C22.2 No 250.0.

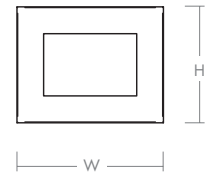
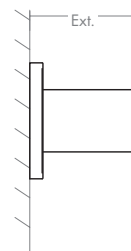
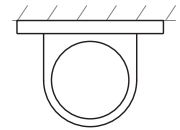

DIMENSIONS

W:	6.00"
H:	4.75"
Ext:	4.38"
M.C:	2.38" From top of fixture

Order example for standard fixture:

3-721-22 (x- Voltage - xxx-Sequence # - xx-Finish)

3: 120V to 277V

Order example for optional color temperatures: **3-721-2722**

27: 2700K, **35:** 3500K, **40:** 4000K

