

**⚠ WARNING/CAUTION**

- **DISCONNECT POWER BEFORE RE-LAMPING OR WIRING THE FIXTURE. READ ALL INSTRUCTIONS COMPLETELY BEFORE STARTING INSTALLATION.**
- **TO AVOID THE RISK OF FIRE OR SHOCK, FIXTURE MUST BE INSTALLED IN COMPLIANCE WITH ALL APPLICABLE NATIONAL AND LOCAL ELECTRICAL/BUILDING CODES. THE INSTALLATION AND MAINTENANCE OF THIS UNIT SHOULD BE COMPLETED BY A LICENSED ELECTRICIAN OR CERTIFIED FACTORY TRAINED TECHNICIAN.**
- **CALIFORNIA PROP 65: THIS LIGHTING FIXTURE CONTAINS CHEMICALS KNOWN TO THE STATE OF CALIFORNIA TO CAUSE CANCER, BIRTH DEFECTS, AND/OR OTHER REPRODUCTIVE HARM. WASH HANDS AFTER USE.**
- **REMOVE THE FIXTURE, PARTS AND PARTS BAG(S) FROM THE CARTON. BEFORE DISCARDING THE CARTON, DOUBLE CHECK TO MAKE CERTAIN THAT ALL PARTS ARE FOUND. INSPECT THE FIXTURE PRIOR TO INSTALLATION FOR ANY DAMAGE TO THE FIXTURE.**
- **DIMMING: THE FIXTURE CAN BE CONTROLLED BY A WALL DIMMING DEVICE. ONLY USE TRIAC/ELECTRONIC DIMMER. MAKE SURE THE CARTON IS MARKED FOR USE WITH LED COMPACT FLUORESCENT-INCANDESCENT LIGHT SOURCE ONLY. THESE CAN BE PROVIDED BY YOUR LOCAL ELECTRICAL DISTRIBUTOR, HOME CENTER, OR HARDWARE STORE.**
- **PLEASE CLEAN WITH A SOFT, DRY CLOTH ONLY! DO NOT USE CLEANSERS**

**FIXTURE INSTALLATION**

1. Thread the 2 MOUNTING SCREWS (2) into the MOUNTING PLATE (1). (the green screw is in the front ). Attach the mounting ring to the junction box. Then thread the nipple into the MOUNTING PLATE (1) and the hex nut onto the nipple.
2. Remove the threaded ring from the SCREW COLLAR LOOP (3). Fully thread the SCREW COLLAR LOOP (3) onto the nipple. Place the CANOPY (4) over the screw collar loop and against the ceiling. Adjust the nipple so that  $\frac{1}{4}$ " of threads on the screw collar loop extend beyond the canopy. Then remove the canopy and tighten the hex nut against the mounting plate.
3. Open the LOCK LINKS (5) and attach to the screw collar loop. Close the top LOCK LINK (5). Hang the fixture on the chain at the desired height. Remove excess chain. Close the bottom LOCK LINK on fixture LOOP (6). Unscrew the ring from the screw collar loop. Let the ring and canopy slide down the chain to the top of the fixture. Thread the lead wires and ground wire (first) through chain, ring and then the canopy.
4. When the ceiling is reached, measure 6" beyond the chain and cut off the excess wire. Separate the leads and strip of approx.  $\frac{1}{2}$ " of insulation from each lead. Twist the strands of wire together. Push the leads and ground wire up through the screw collar loop and nipple and into the junction box.
5. Attach the Ground wire (Green) to the ground inside the outlet box (Generally green or bar copper wire) or the GROUND SCREW (7) on the MOUNTING PLATE (1). **NEVER CONNECT GROUND WIRE TO "HOT" WIRE! FAILURE TO FOLLOW THIS COULD RESULT IN SERIOUS INJURY OR DEATH!**
6. Connect the white fixture lead to the neutral (Generally white) wire in the outlet box. Fasten the wires together with an approved fastener (WIRE NUTS) (8). Starting 1" below the fastener, tightly wrap the connection with electrical tape so that the connections seals the end of the fastener. **MAKE SURE THERE ARE NO EXPOSED WIRE OF STRANDS THAT COULD CAUSE A DANGEROUS SHORT CIRCUIT!**
7. Connect the black fixture leads to the hot (Generally black) wire in the outlet box. Fasten the joined wires same as previous step. **NEVER REVERSE HOT AND NEUTRAL WIRES. FAILURE TO FOLLOW THIS COULD RESULT IN SERIOUS INJURY OR DEATH!**
8. Slide the CANOPY (4) and screw collar ring up the chain and secure the canopy to the ceiling.
9. Put the NIPPLE (9) , POLE (10) onto FIXTURE and TWIST with LOOP (11). Put CANDLE SLEEVES (12) onto CANDLE CUPS (8), adjust it on straight.
10. Push the BULBS (13) (not included) up into the sockets of the fixture. **THIS FIXTURE IS RATED FOR 60 WATT TYPE B LAMP. DO NOT EXCEED THE RECOMMENDED WATTAGE!**
11. Restore power to the outlet at the breaker or fuse box.

ITEM	DESCRIPTION	PART NUMBER
1	MOUNTING PLATE	HDW-F1007
2	MOUNTING SCREW	HDW-F1007
3	SCREW COLLAR LOOP	HDW-F1007
4	CANOPY	CPY-F1007
5	LOCK LINKS	LNK-F1007
6	GROUND SCREW	HDW-F1007
7	WIRE NUTS	HDW-F1007
8	CANDLE CUPS	CDL-F1007
9	NIPPLE	HDW-F1007
10	POLE	HRD-F1007
11	LOOP	LOO-F1007
12	CANDLE SLEEVES	CDL-F1007-S
13	BULBS	NOT INCLUDED

**⚠ ATTENTION PRUDENCE**

- DÉBRANCHEZ L'ALIMENTATION AVANT DE REMPLIR OU DE CÂBLER LE LUMINAIRE. LISEZ COMPLÈTEMENT TOUTES LES INSTRUCTIONS AVANT DE COMMENCER L'INSTALLATION
- POUR ÉVITER LE RISQUE D'INCENDIE OU D'ÉLECTROCUTION, LE LUMINAIRE DOIT ÊTRE INSTALLÉ CONFORMÉMENT À TOUS LES CODES ÉLECTRIQUES/DE CONSTRUCTION NATIONAUX ET LOCAUX APPLICABLES. L'INSTALLATION ET L'ENTRETIEN DE CET APPAREIL DOIVENT ÊTRE EFFECTUÉS PAR UN ÉLECTRICIEN AGRÉÉ OU UN TECHNICIEN CERTIFIÉ FORMÉ EN USINE.
- CALIFORNIE PROP 65 : CET APPAREIL D'ÉCLAIRAGE CONTIENT DES PRODUITS CHIMIQUES CONNUS PAR L'ÉTAT DE CALIFORNIE POUR PROVOQUER LE CANCER, DES MALADIES CONGÉNITALES ET/OU D'AUTRES DOMMAGES À LA REPRODUCTION. LAVER LES MAINS APRÈS UTILISATION.
- RETIRER LE LUMINAIRE, LES PIÈCES ET LE(S) SAC(S) DE PIÈCES DU CARTON. AVANT DE JETER LE CARTON, VÉRIFIEZ DOUBLE POUR VOUS ASSURER QUE TOUTES LES PIÈCES SONT TROUVÉES. INSPECTER LE LUMINAIRE AVANT L'INSTALLATION POUR TOUT DOMMAGE AU LUMINAIRE.
- GRADATION : LE LUMINAIRE PEUT ÊTRE CONTRÔLÉ PAR UN DISPOSITIF DE GRADATION MURALE. UTILISER UNIQUEMENT UN GRADATEUR TRIAC/ÉLECTRONIQUE. ASSUREZ-VOUS QUE LE CARTON EST MARQUÉ POUR UNE UTILISATION AVEC UNE SOURCE DE LUMIÈRE FLUORESCENTE À INCANDESCENTE COMPACTE UNIQUEMENT. CEUX-CI PEUVENT ÊTRE FOURNIS PAR VOTRE DISTRIBUTEUR ÉLECTRIQUE LOCAL, CENTRE À DOMICILE OU MAGASIN DE QUINCAILLERIE.
- VEUILLEZ NETTOYER UNIQUEMENT AVEC UN CHIFFON DOUX ET SEC ! N'UTILISEZ PAS DE NETTOYANTS

**FIXTURE INSTALLATION**

1. Thread the 2 MOUNTING SCREWS (2) into the MOUNTING PLATE (1). (the green screw is in the front ). Attach the mounting ring to the junction box. Then thread the nipple into the MOUNTING PLATE (1) and the hex nut onto the nipple.
2. Remove the threaded ring from the SCREW COLLAR LOOP (3). Fully thread the SCREW COLLAR LOOP (3) onto the nipple. Place the CANOPY (4) over the screw collar loop and against the ceiling. Adjust the nipple so that  $\frac{1}{4}$ " of threads on the screw collar loop extend beyond the canopy. Then remove the canopy and tighten the hex nut against the mounting plate.
3. Open the LOCK LINKS (5) and attach to the screw collar loop. Close the top LOCK LINK (5). Hang the fixture on the chain at the desired height. Remove excess chain. Close the bottom LOCK LINK on fixture LOOP (6). Unscrew the ring from the screw collar loop. Let the ring and canopy slide down the chain to the top of the fixture. Thread the lead wires and ground wire (first) through chain, ring and then the canopy.
4. When the ceiling is reached, measure 6" beyond the chain and cut off the excess wire. Separate the leads and strip of approx.  $\frac{1}{2}$ " of insulation from each lead. Twist the strands of wire together. Push the leads and ground wire up through the screw collar loop and nipple and into the junction box.
5. Attach the Ground wire (Green) to the ground inside the outlet box (Generally green or bar copper wire) or the GROUND SCREW (7) on the MOUNTING PLATE (1). **NEVER CONNECT GROUND WIRE TO "HOT" WIRE! FAILURE TO FOLLOW THIS COULD RESULT IN SERIOUS INJURY OR DEATH!**
6. Connect the white fixture lead to the neutral (Generally white) wire in the outlet box. Fasten the wires together with an approved fastener (WIRE NUTS) (8). Starting 1" below the fastener, tightly wrap the connection with electrical tape so that the connections seals the end of the fastener. **MAKE SURE THERE ARE NO EXPOSED WIRE OF STRANDS THAT COULD CAUSE A DANGEROUS SHORT CIRCUIT!**
7. Connect the black fixture leads to the hot (Generally black) wire in the outlet box. Fasten the joined wires same as previous step. **NEVER REVERSE HOT AND NEUTRAL WIRES. FAILURE TO FOLLOW THIS COULD RESULT IN SERIOUS INJURY OR DEATH!**
8. Slide the CANOPY (4) and screw collar ring up the chain and secure the canopy to the ceiling.
9. Put the NIPPLE (9) , POLE (10) onto FIXTURE and TWIST with LOOP (11). Put CANDLE SLEEVES (12) onto CANDLE CUPS (8), adjust it on straight.
10. Push the BULBS (13) (not included) up into the sockets of the fixture. **THIS FIXTURE IS RATED FOR 60 WATT TYPE B LAMP. DO NOT EXCEED THE RECOMMENDED WATTAGE!**
11. Restore power to the outlet at the breaker or fuse box.

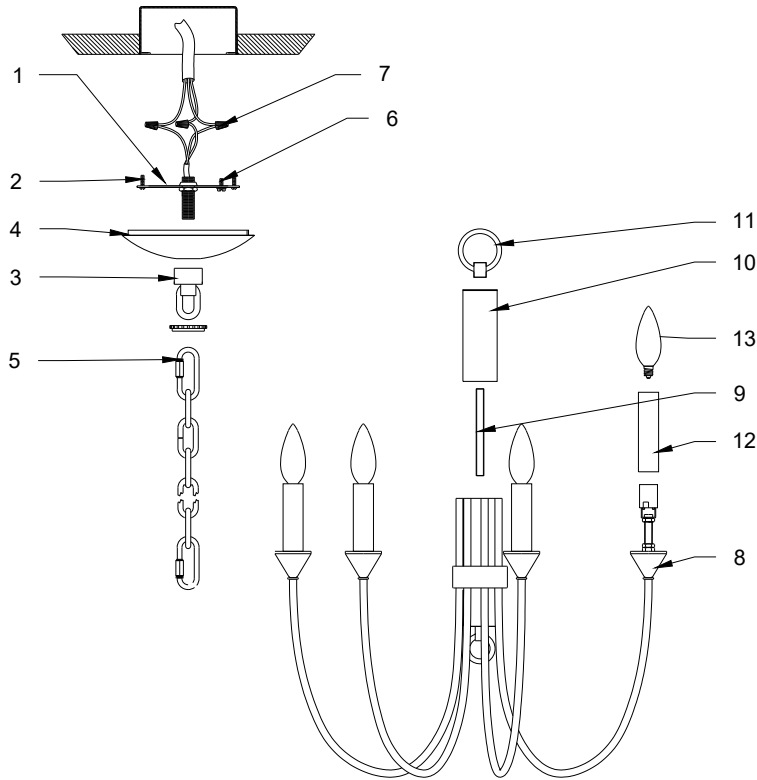

ITEM	DESCRIPTION	PART NUMBER
1	MOUNTING PLATE	HDW-F1007
2	MOUNTING SCREW	HDW-F1007
3	SCREW COLLAR LOOP	HDW-F1007
4	CANOPY	CPY-F1007
5	LOCK LINKS	LNK-F1007
6	GROUND SCREW	HDW-F1007
7	WIRE NUTS	HDW-F1007
8	CANDLE CUPS	CDL-F1007
9	NIPPLE	HDW-F1007
10	POLE	HRD-F1007
11	LOOP	LOO-F1007
12	CANDLE SLEEVES	CDL-F1007-S
13	BULBS	NOT INCLUDED